

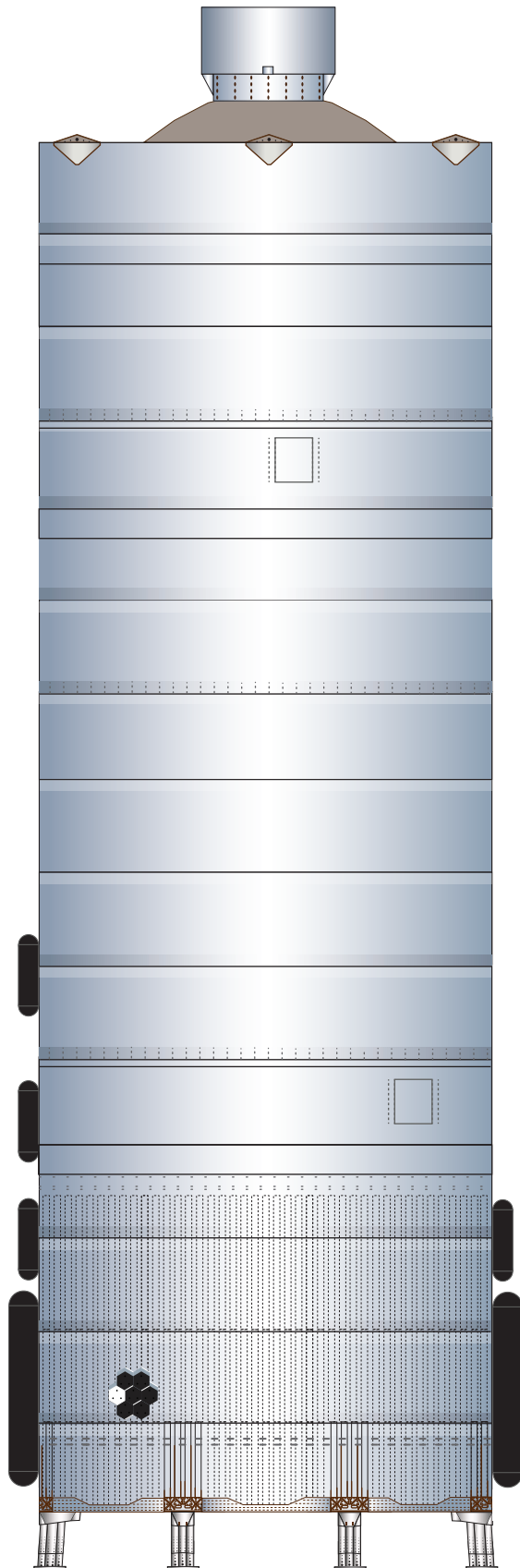

1:100 Scale

SN-6



S
T
A
R
S
H
I
P

Designed by Alfonso X Moreno
©2020 Not for commercial use



SpaceX Starship SN-6

Print on Cardstock (110 lbs)

REFERENCE

NOT TO SCALE

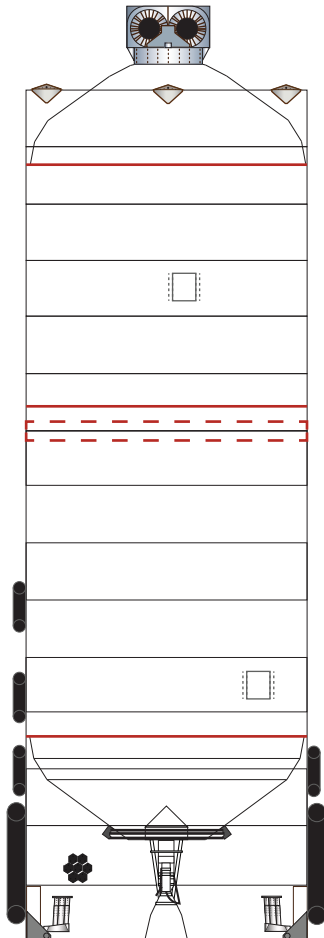

Front

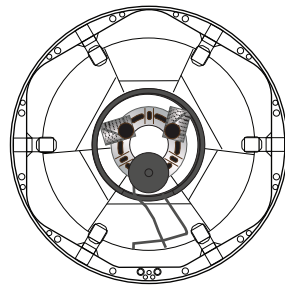

Back

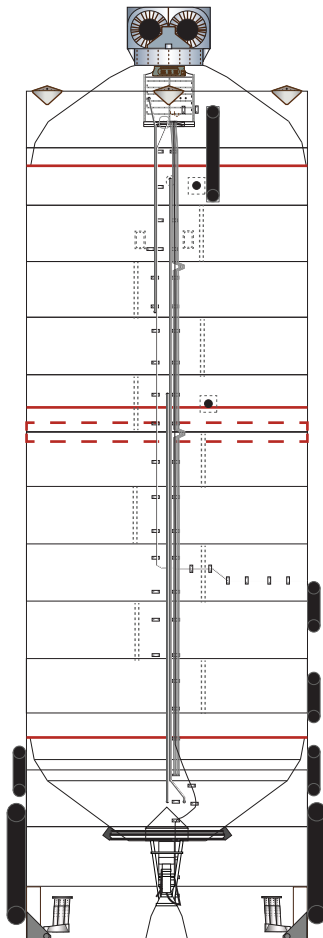

Back



SpaceX Starship SN-6

Print on Cardstock (110 lbs)

Revised

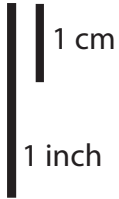

Mass Simulator

1:100 Scale

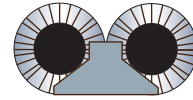
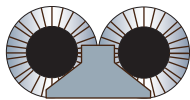
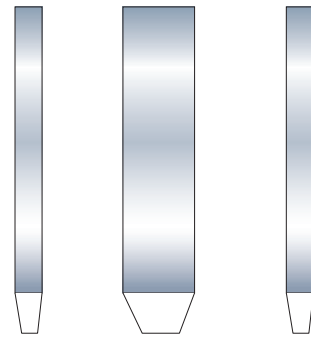
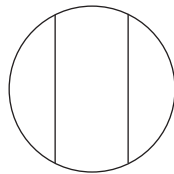
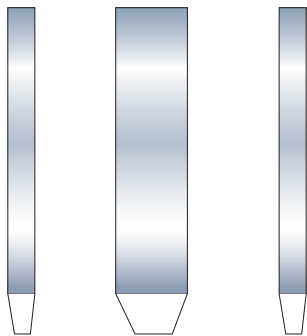
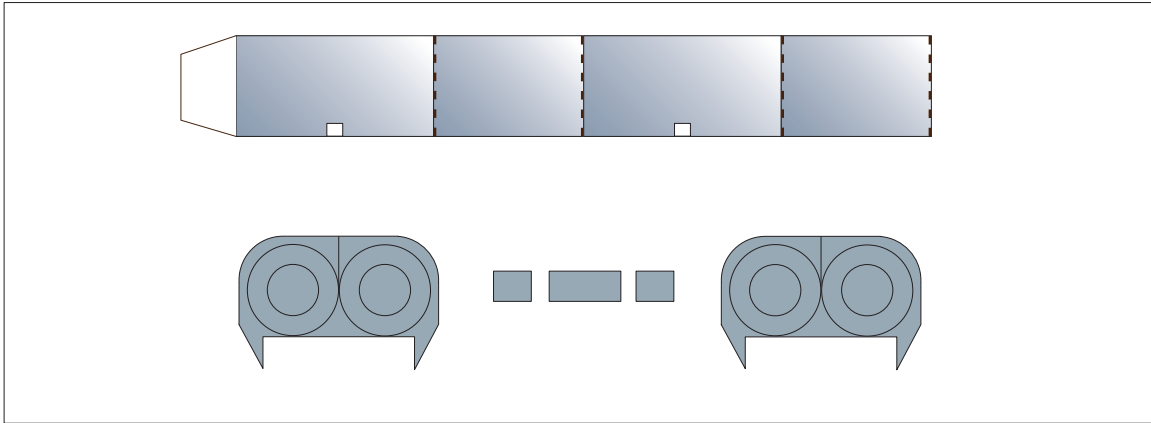

Tesla Battery

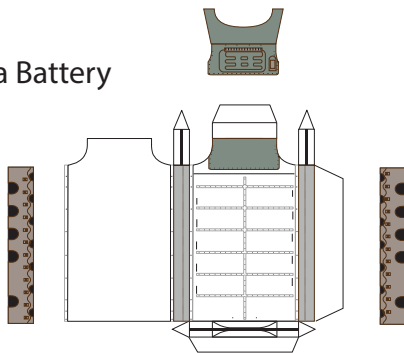

Diagram

Side

Front

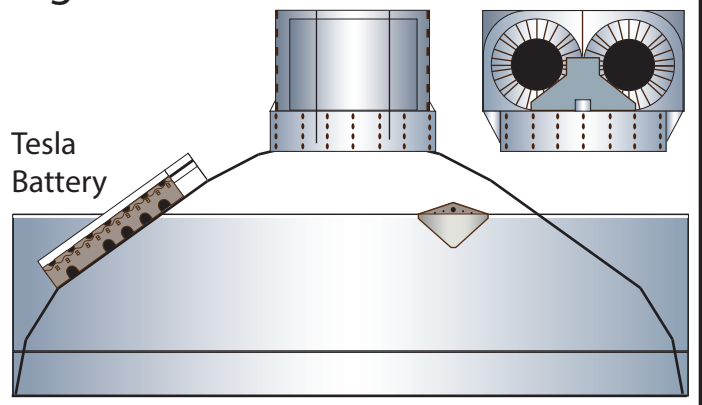

SpaceX Starship SN-6

Back Print





1 cm

1 inch

1:100 Scale

Starship SN6 Upper Dome

Print on Cardstock (110 lbs)

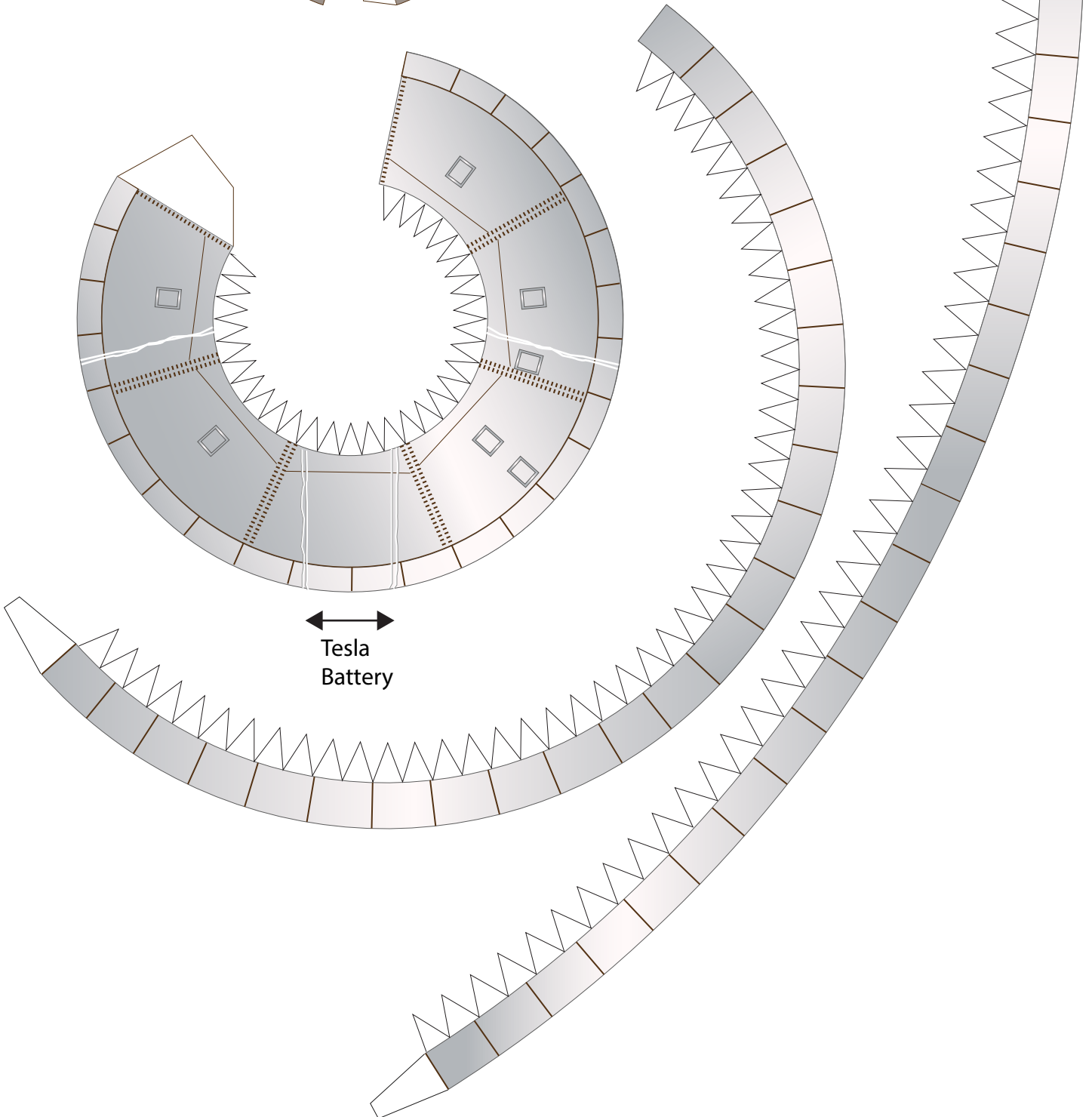
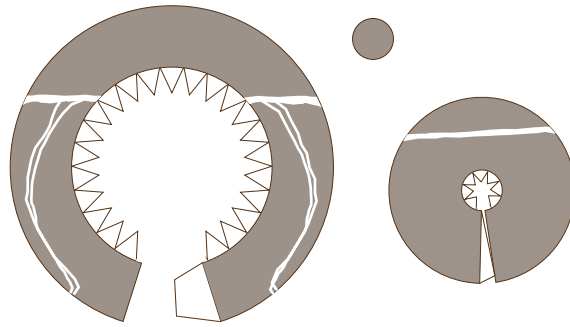



1:100 Scale



SpaceX Starship SN-6

Former for upper dome

Print on Cardstock (110 lbs)

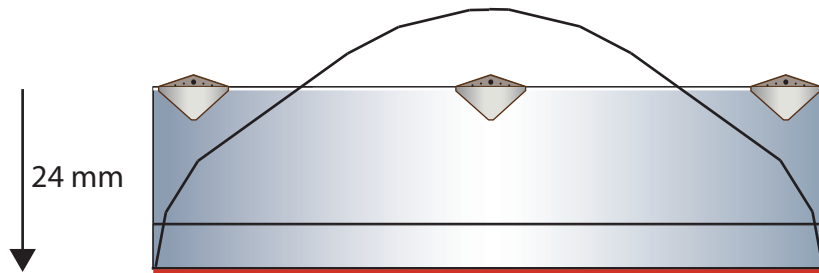
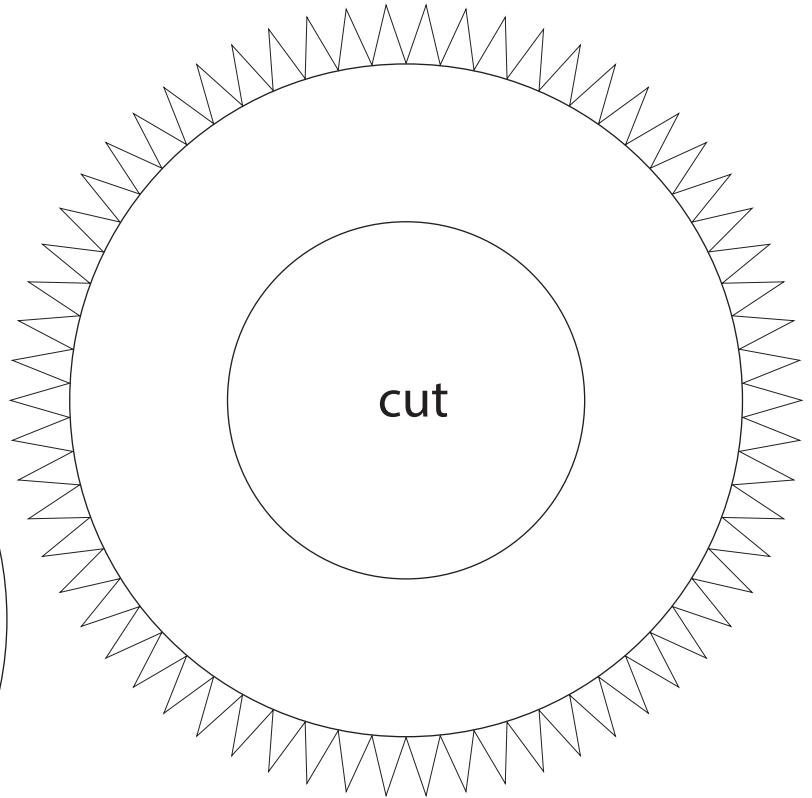
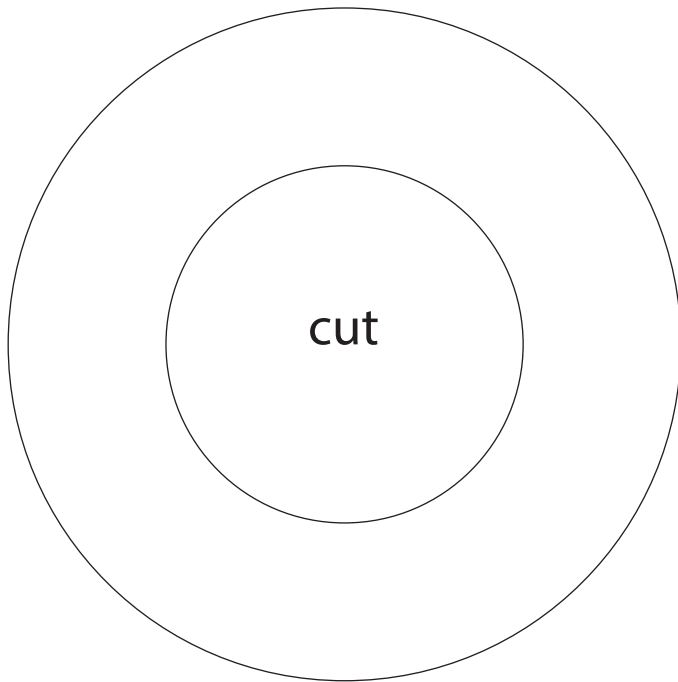

IMPORTANT

Top former is glued 24 mm from top edge of upper body for Starship SN-6 model



1:100 Scale



SpaceX Starship SN6

Print on Cardstock (110 lbs)

Front top

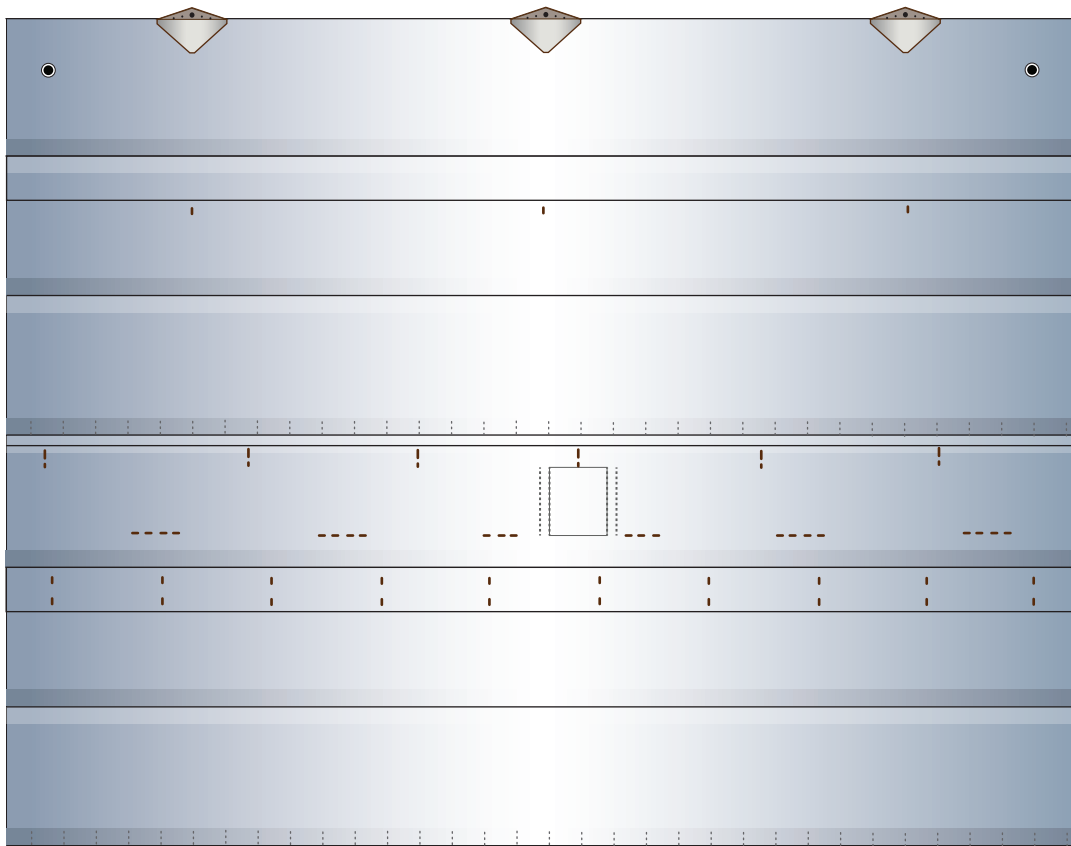
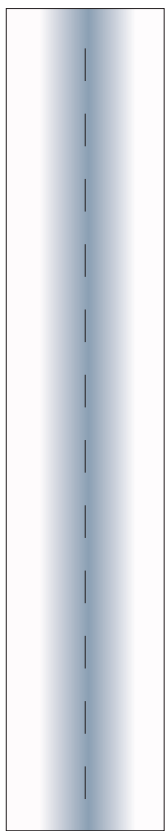
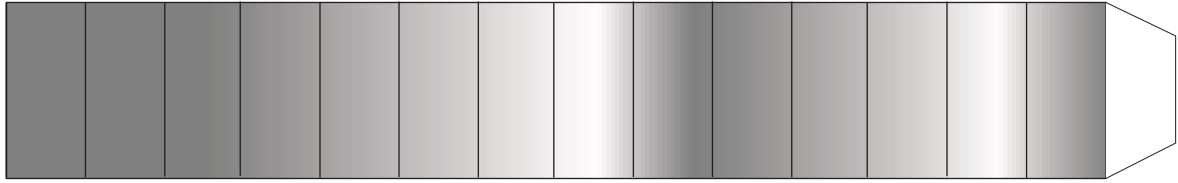



1:100 Scale

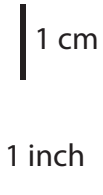

SpaceX Starship SN6

Print on Cardstock (110 lbs)

Back top

Revised

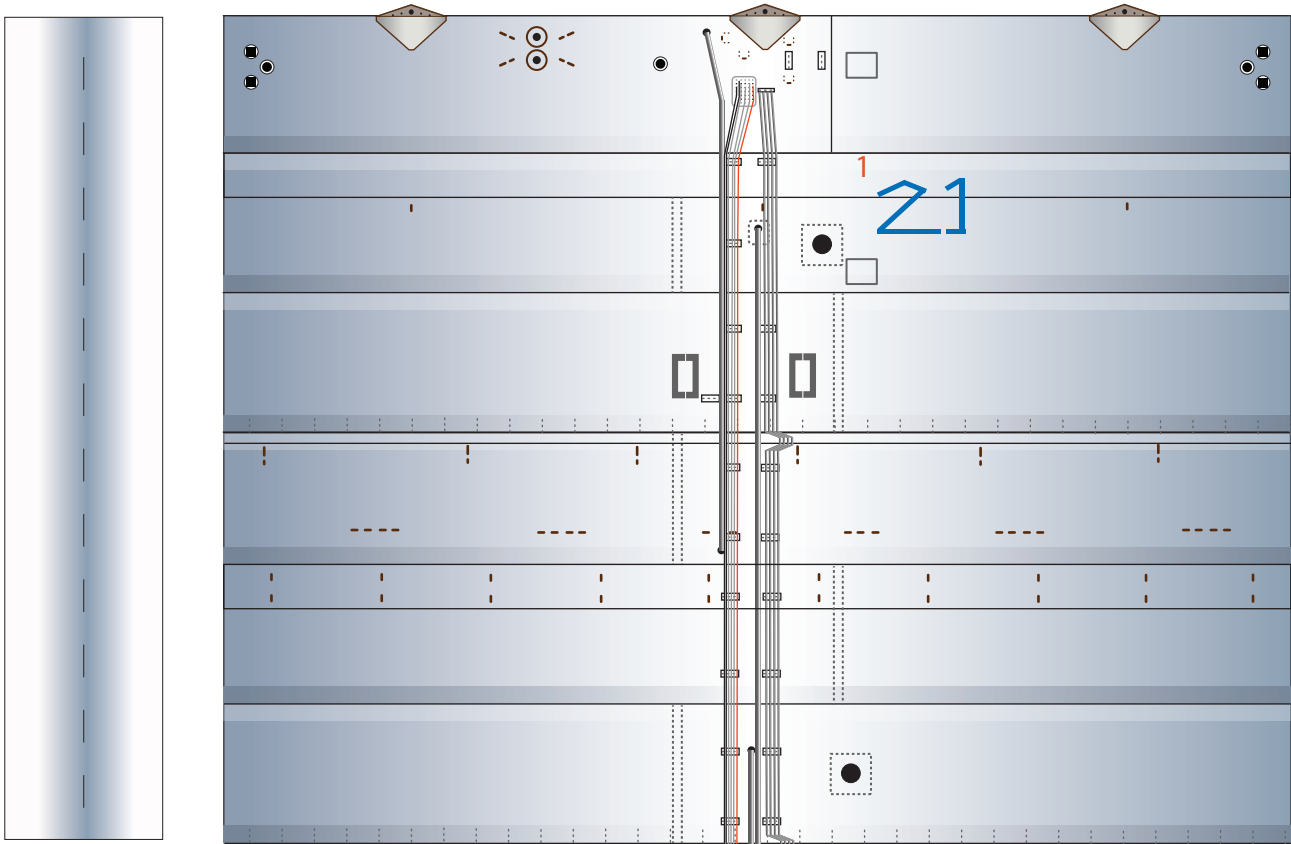
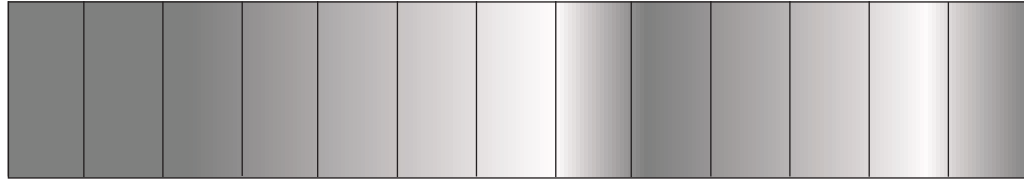



1:100 Scale



SpaceX Starship SN6

Print on Cardstock (110 lbs)

Front bottom

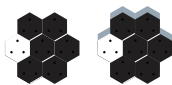
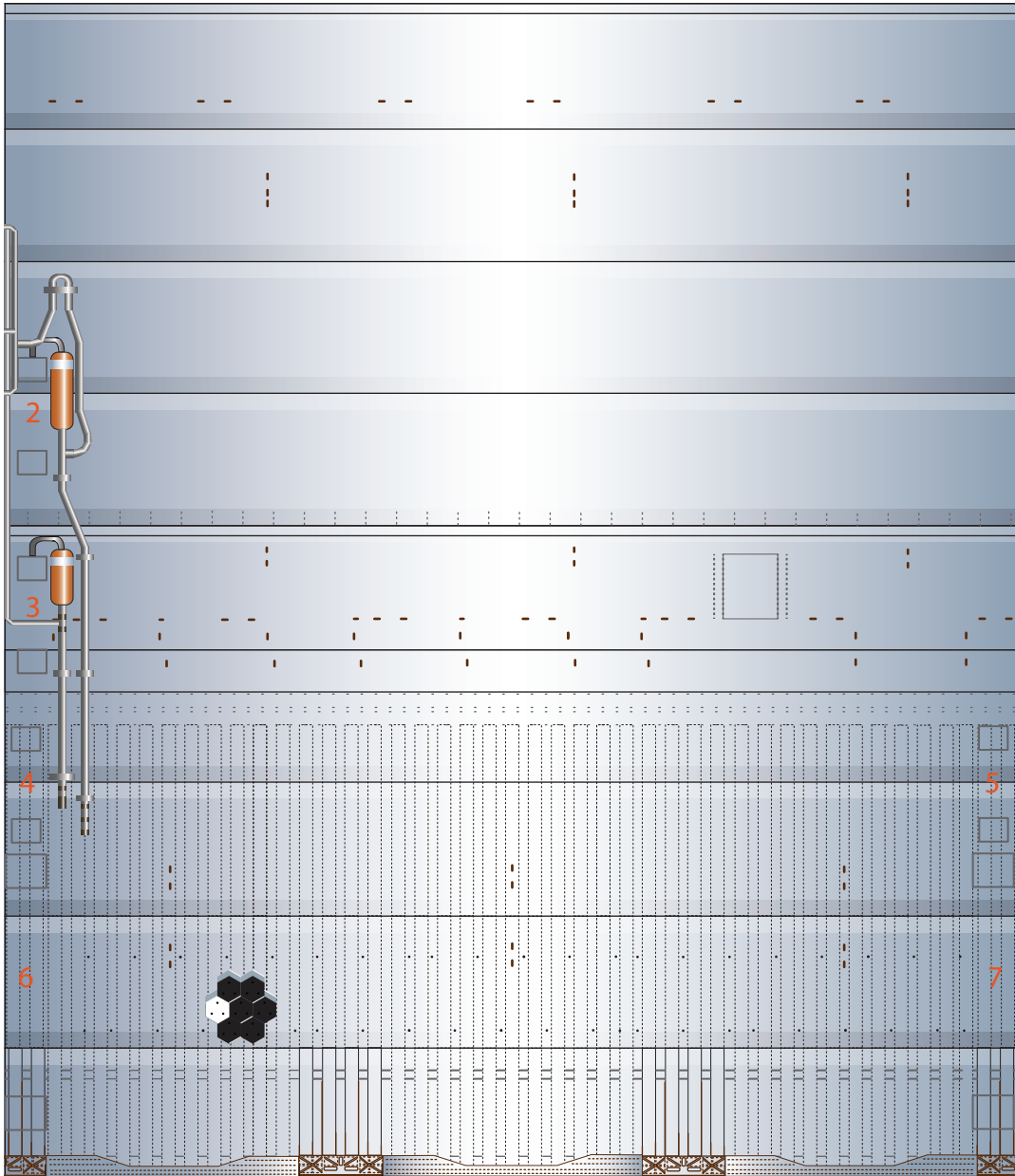
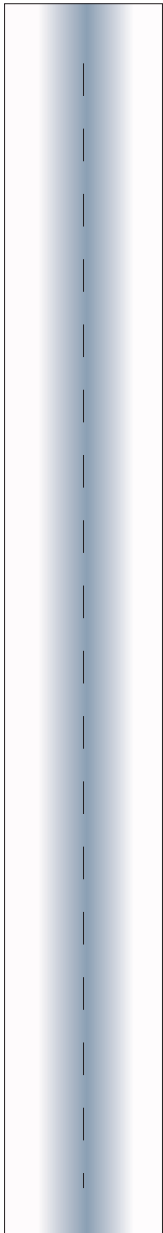

-Z



1:100 Scale



SpaceX Starship SN6

Print on Cardstock (110 lbs)

Revised

Back bottom

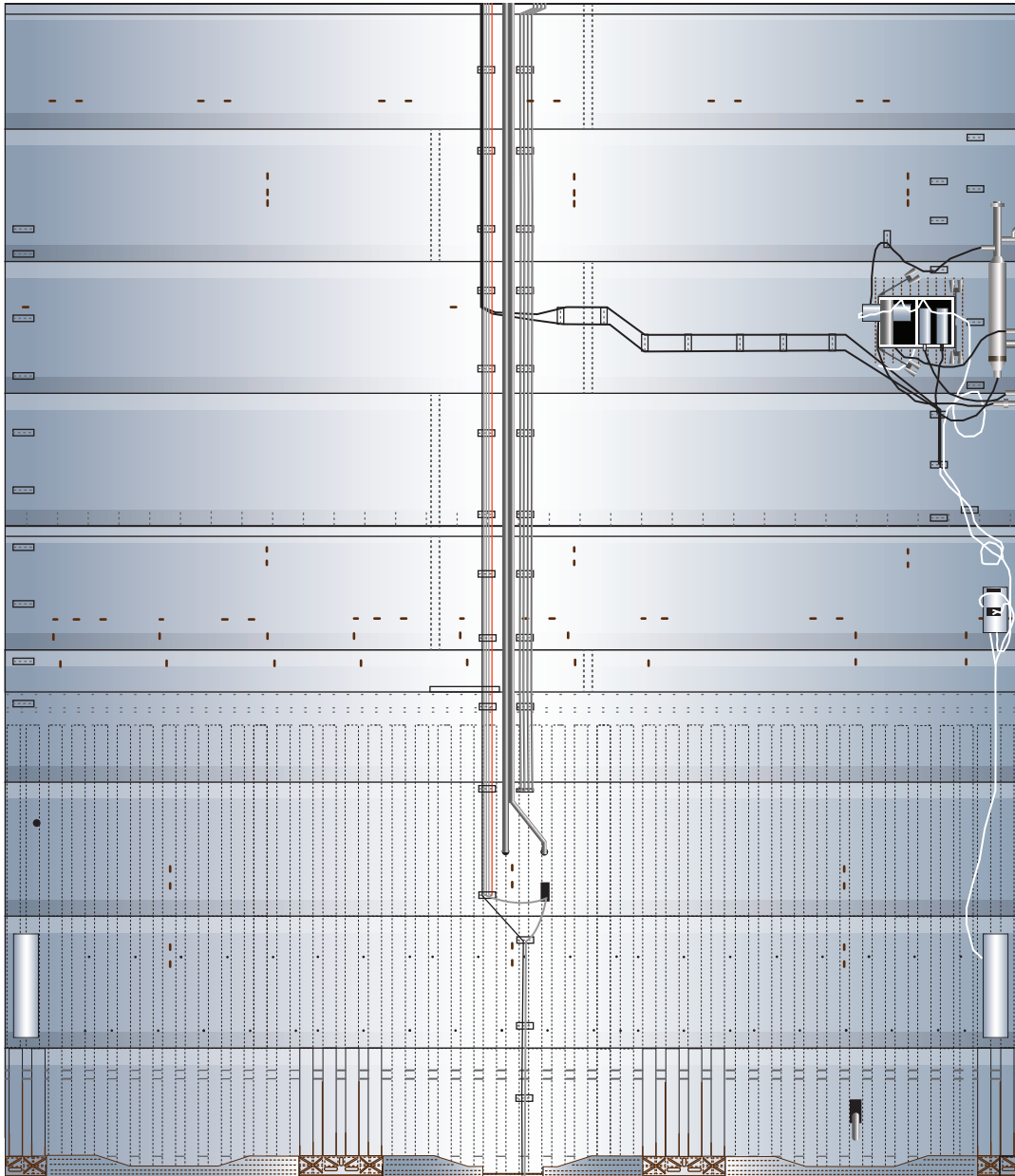
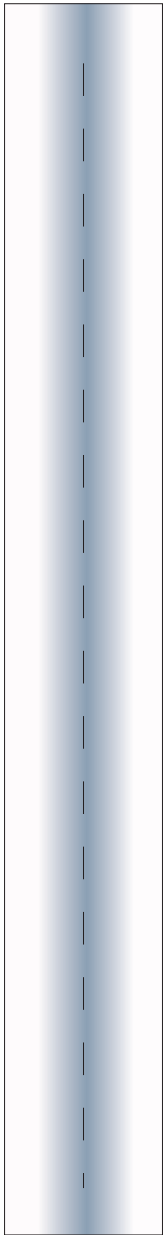

+Z



1:100 Scale



SpaceX Starship SN6

Print on Cardstock (110 lbs)

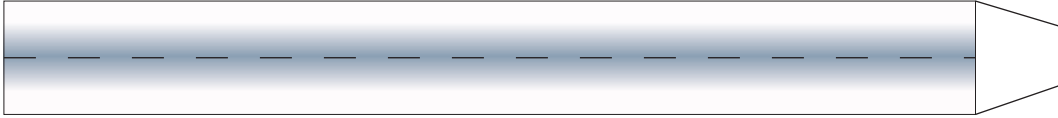

Connectors for upper and lower body

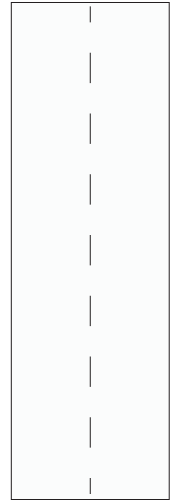
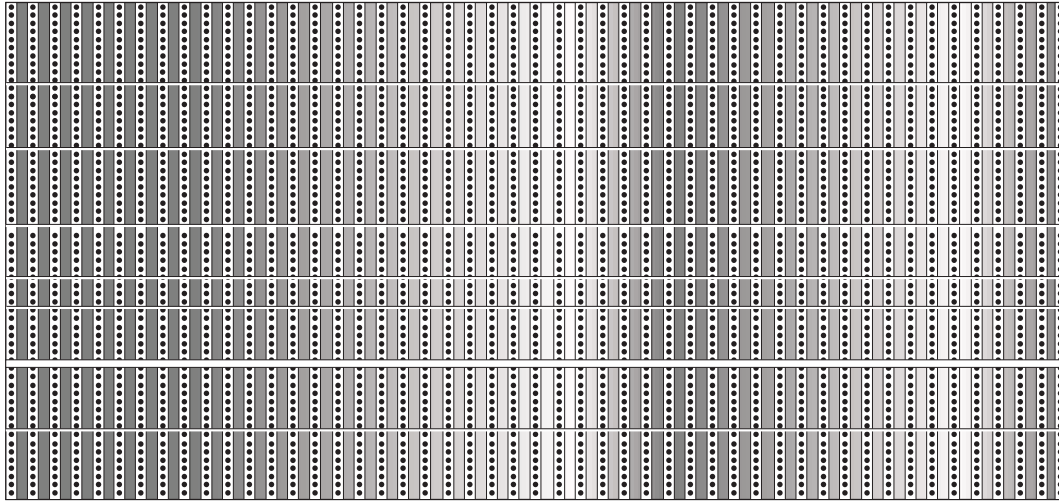
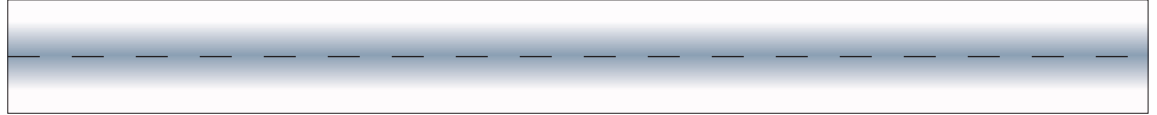

Engine section interior wall

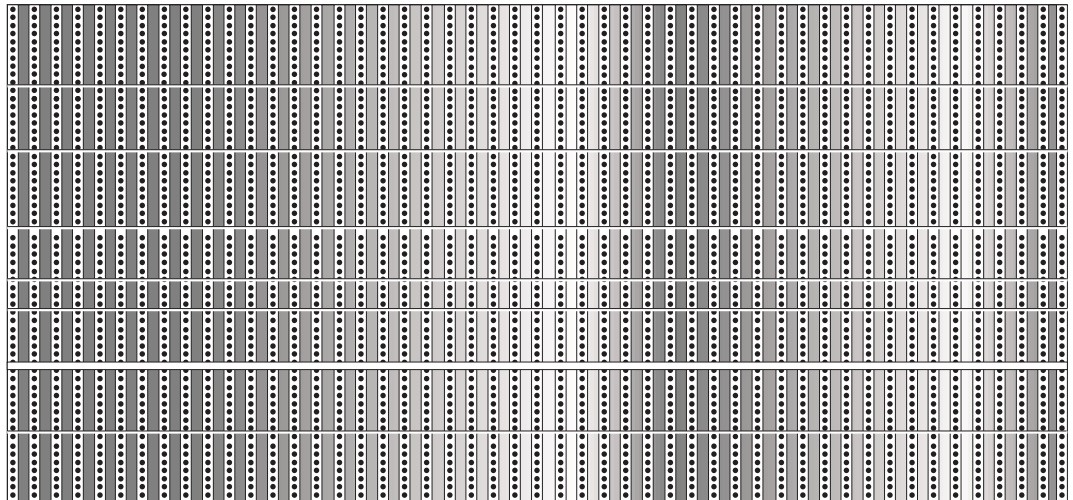



1 cm

1 inch

SpaceX Starship SN-6

Print on Cardstock (110 lbs)

Landing Legs

1:100 Scale

Back

Back

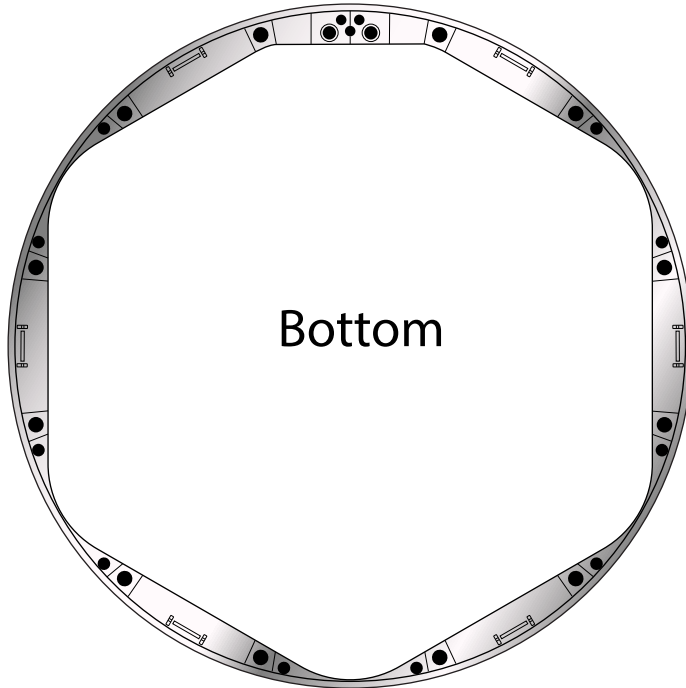

Bottom

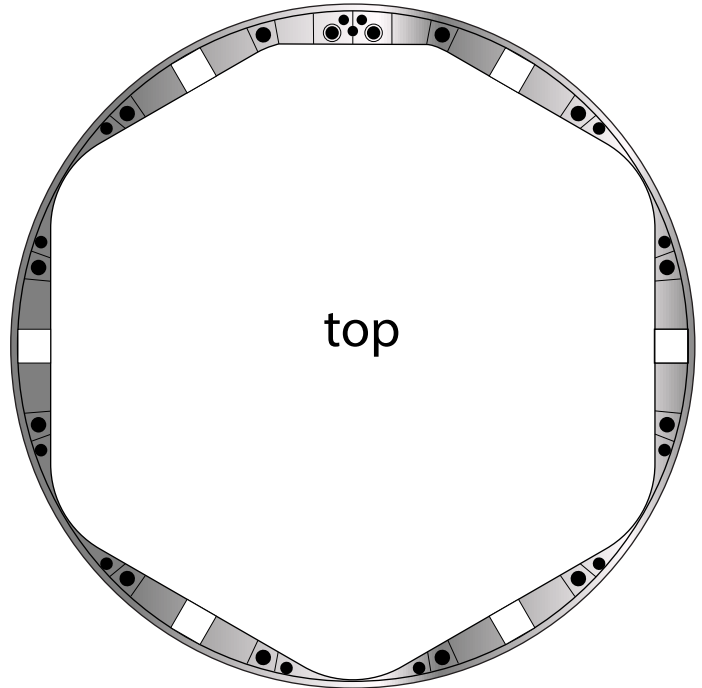

top

Leg support pillars

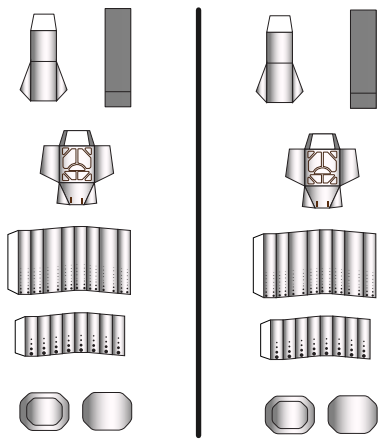
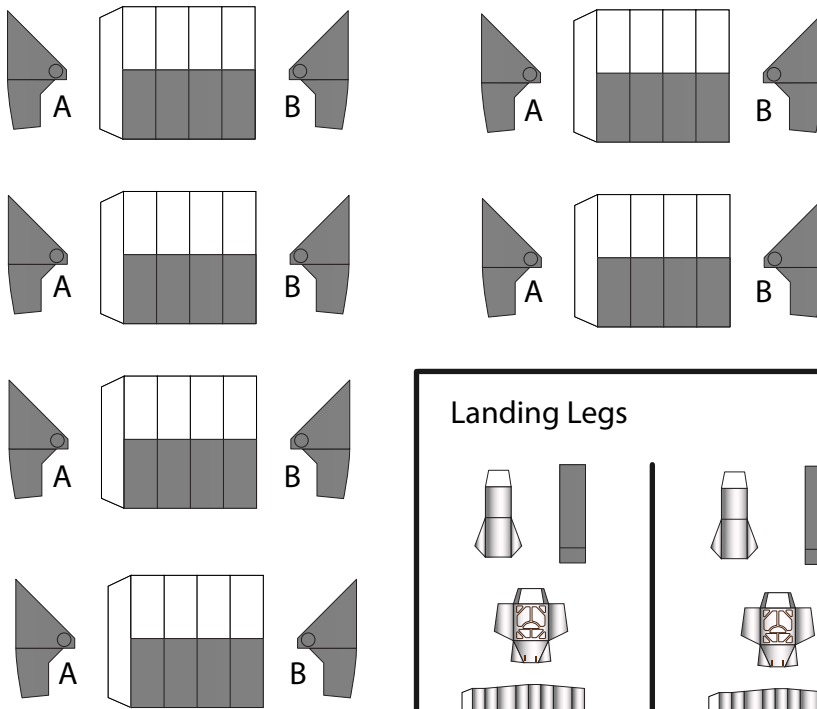

Landing Legs

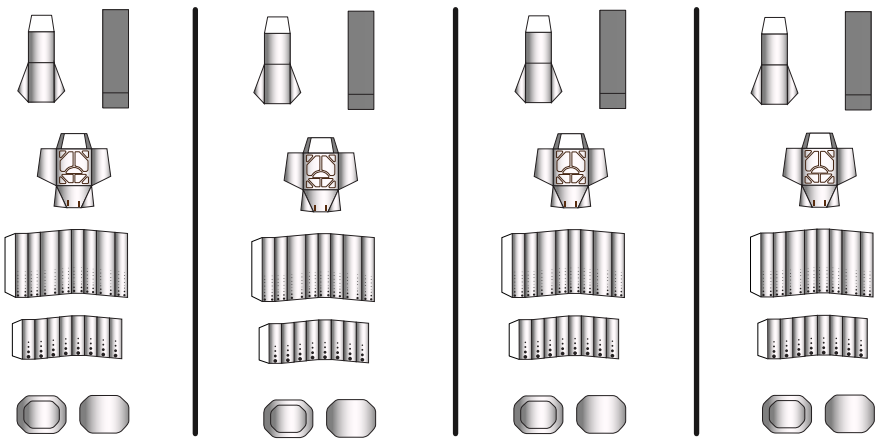

Use a cottonswab stick (2 mm diameter) and cut 6 segments of 5 mm in length and glue them between parts A and B.



1:100 Scale



SpaceX Starship SN6

Print on Cardstock (110 lbs)

Formers for lower body

Revised

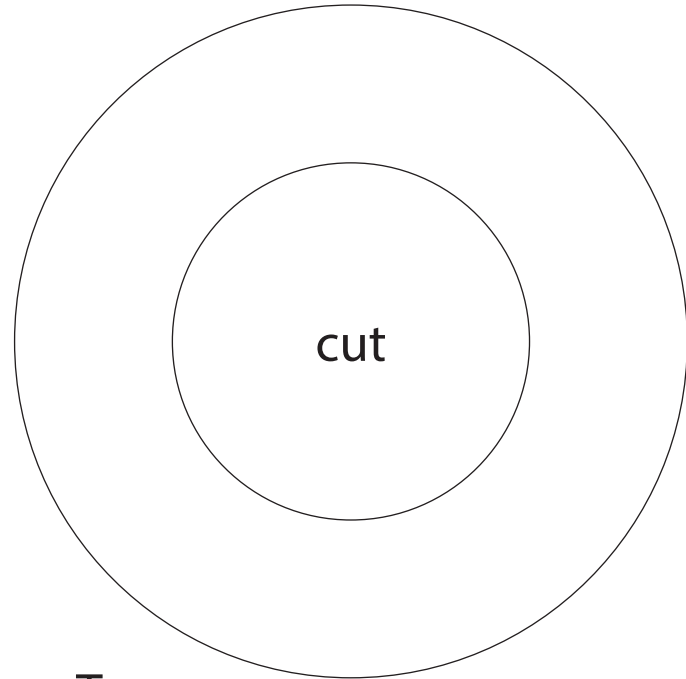

Top

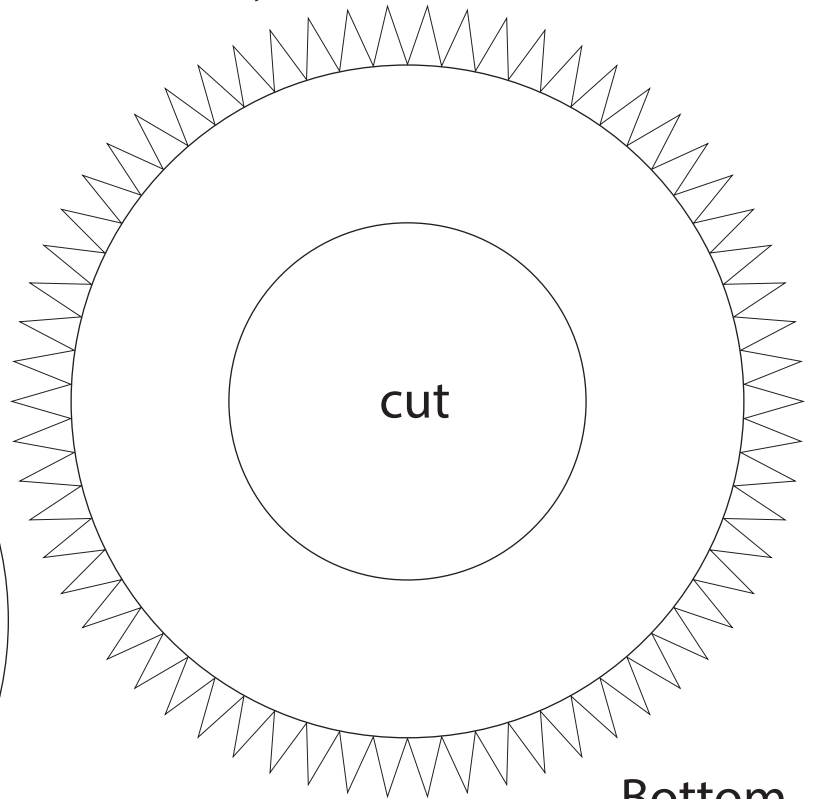

Bottom

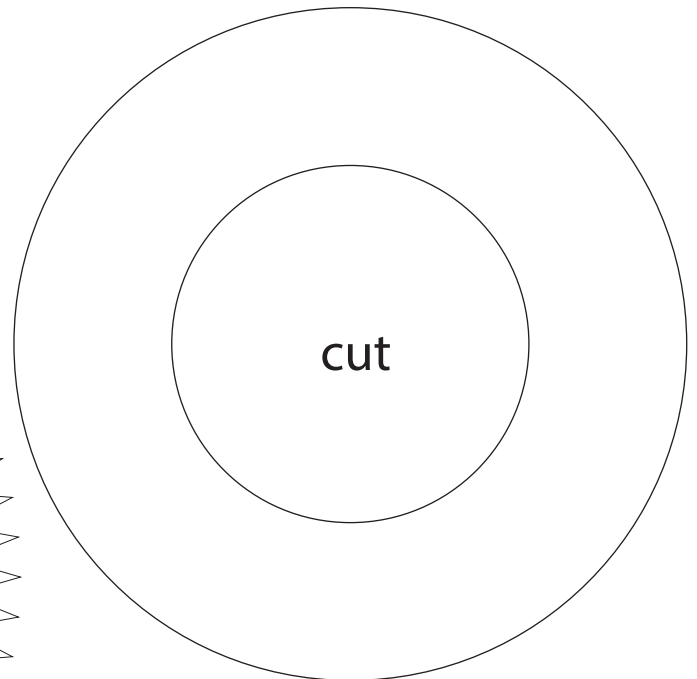
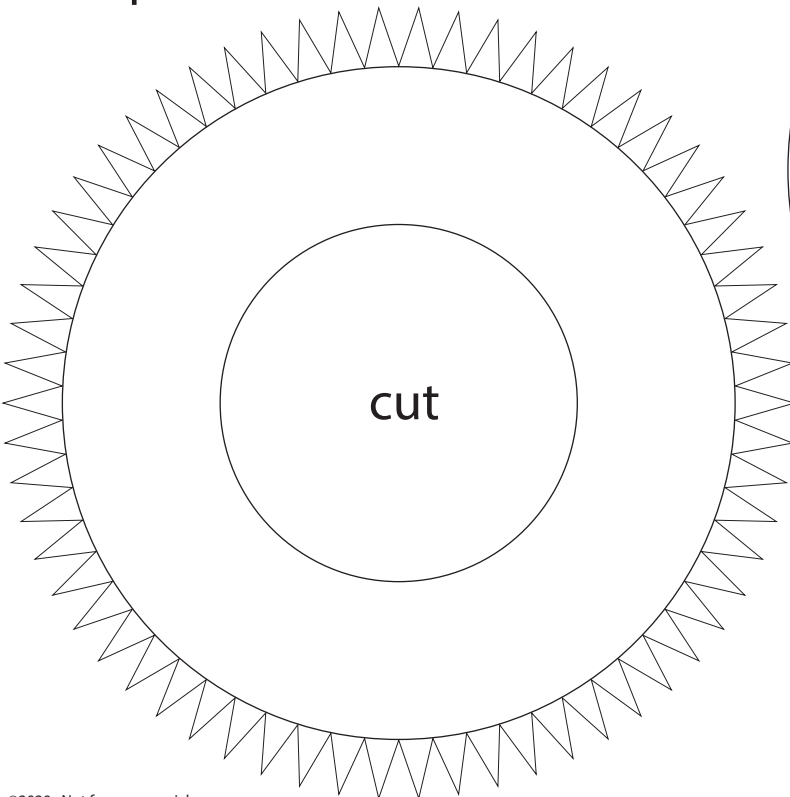

IMPORTANT

Top former is glued 20 mm from bottom edge of upper body.
Bottom former is glued 66 mm from bottom edge of lower body.



1 cm

1 inch

1:100 Scale

Starship SN-6 Bulkhead

Print on Cardstock (110 lbs)

Raptor facing aft

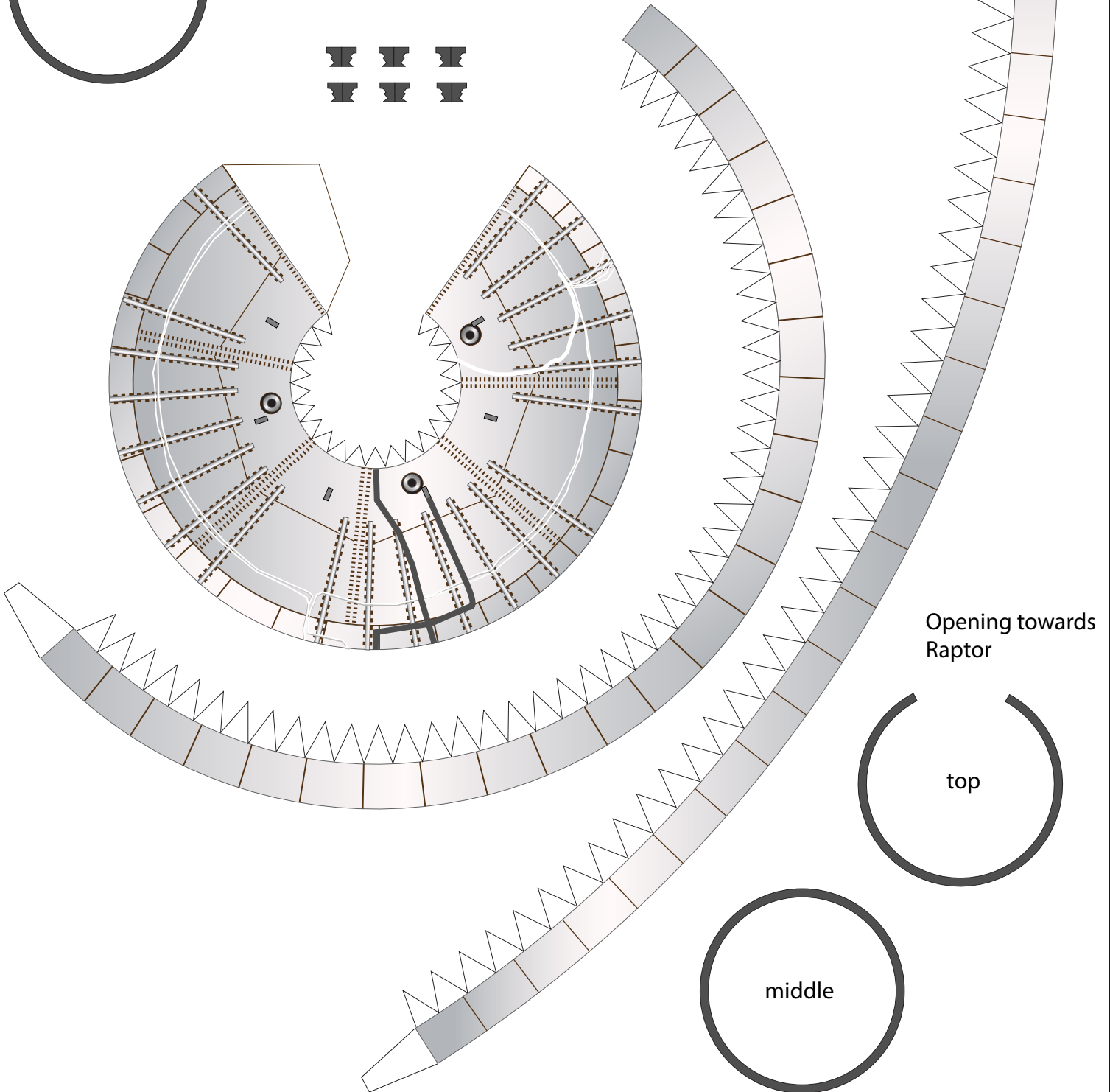
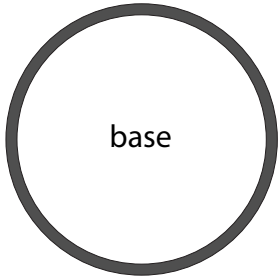
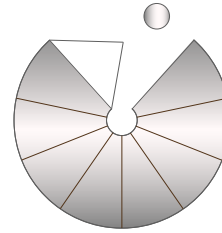
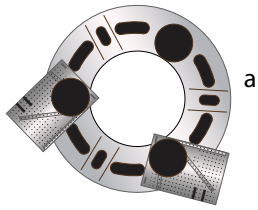
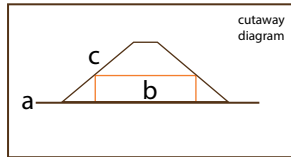

Opening towards Raptor

top

middle



1 cm

1 inch

1:100 Scale

SpaceX Starship SN6

Print on Cardstock (110 lbs)

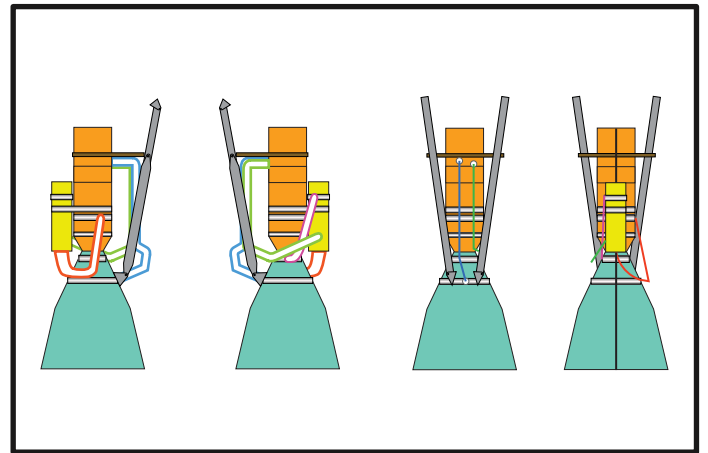
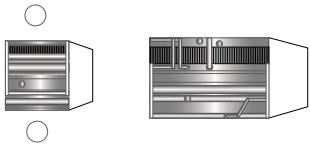
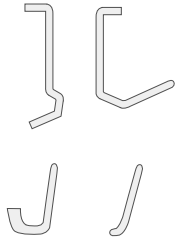
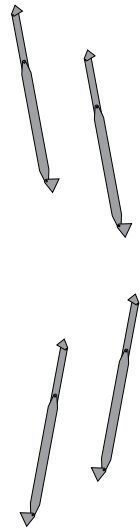
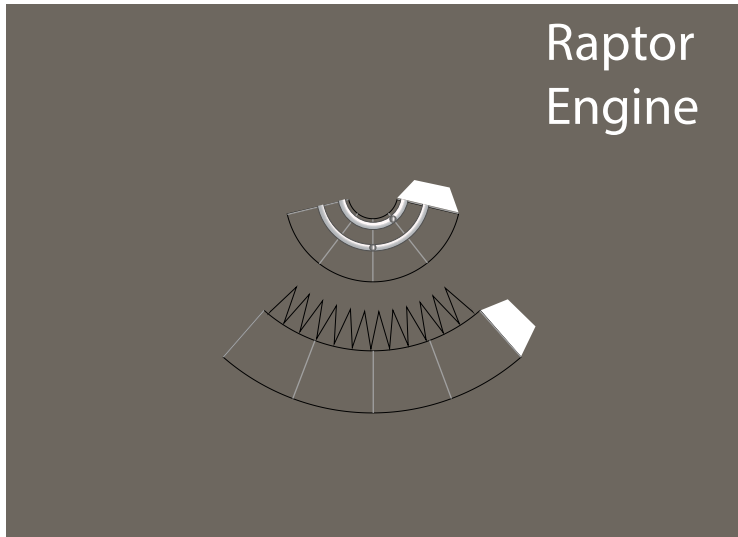

COPVs

